

● Usage

Machine and Tools

1. Use hammer and punch
2. Use drilling machine
3. Use soldering gun

※Temp control deposition machine & various punches.

Insertion method

Press fit Thermal deposition

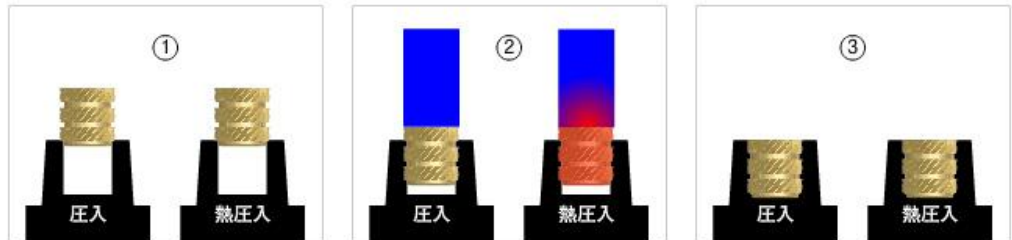

①Set insert→②Press fit→③Complete

Parent material dimensions

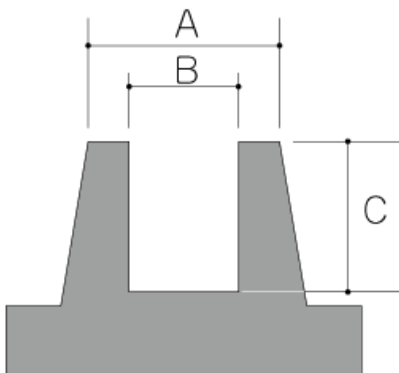

A : Twice or more length of the insert nut

B : Diameter "D1" + 0.05mm (below table)

C : Total length "L" + 0.2mm or more (below table)

Notes at using

Testing is necessary about the shape of resin hole because various situations are considered.

● Reference of Strength

Torque(N-m)				Resin	Tension(N)			
M3 SB-3001	M4 SB-4001	M5 SB-5002	M6 SB-6002		M3 SB-3001	M4 SB-4001	M5 SB-5002	M6 SB-6002
1.8	2.5	4.5	5.1	ABS	559	765	1177	1765
1.9	3.0	5.0	6.8	PPO	618	981	1471	1765
2.0	3.0	5.2	6.4	Polycarbo	883	1177	1520	1814

● Dimensions table

SB (Standard Bit)

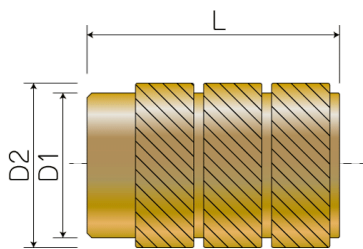

※Knurling part is changed when insert length is changed.
Put "Z" at the end of Part No, if you need "no direction type."

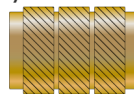

Example:SB-4001Z

Thread M1.4×0.3

D1	D2	L	Part No.	Pieces / Box
3.0	3.3	2.5	SB-1401	10,000
3.0	3.3	3.0	SB-143030	10,000

Thread M1.6×0.35

D1	D2	L	Part No.	Pieces / Box
3.0	3.3	4.0	SB-163040	18,000

Thread M1.7×0.35

D1	D2	L	Part No.	Pieces / Box
3.0	3.3	2.5	SB-173025	10,000
3.0	3.3	4.0	SB-173040	8,000
3.5	3.8	4.0	SB-173540	6,000

Thread M2×0.4

D1	D2	L	Part No.	Pieces / Box
3.0	3.3	2.0	SB-203020	15,000
3.0	3.3	2.5	SB-203025	15,000
3.0	3.3	3.0	SB-203030	10,000
3.0	3.3	3.3	SB-2001	10,000
3.0	3.3	3.5	SB-203035	10,000

D1	D2	L	Part No.	Pieces / Box
3.0	3.3	4.0	SB-203040	8,000
3.0	3.3	4.5	SB-203045	8,000
3.0	3.3	5.5	SB-203055	6,000
3.0	3.3	6.0	SB-203060	5,000
3.0	3.3	8.0	SB-203080	4,000
3.5	3.8	3.0	SB-203530	10,000
3.5	3.8	4.0	SB-203540	7,000
4.0	4.3	3.0	SB-204030	7,000
4.0	4.3	5.0	SB-204050	4,000
4.0	4.3	6.0	SB-204060	4,000
4.0	4.3	7.0	SB-204070	3,000

Thread M2.6×0.45

D1	D2	L	Part No.	Pieces / Box
3.5	3.8	2.5	SB-263525	8,000
3.5	3.8	3.0	SB-263530	8,000
4.0	4.3	2.5	SB-264025	8,000
4.0	4.3	3.0	SB-264030	7,000
4.0	4.3	3.5	SB-264035	6,000
4.0	4.3	4.0	SB-264040	5,000
4.0	4.3	5.0	SB-2601	4,000
4.0	4.3	6.0	SB-264060	3,000
4.5	4.8	3.5	SB-264535	5,000
4.5	4.8	4.0	SB-264540	4,000
4.5	4.8	5.0	SB-264550	3,000

D1	D2	L	Part No.	Pieces / Box
4.5	4.8	7.0	SB-2602	2,500

Thread M3×0.5

D1	D2	L	Part No.	Pieces / Box
4.5	4.8	2.0	SB-304520	8,000
4.5	4.8	3.0	SB-304530	6,000
4.5	4.8	4.0	SB-304540	4,000
4.5	4.8	4.8	SB-3006	4,000
4.5	4.8	5.0	SB-304550	3,000
4.5	4.8	6.0	SB-304560	3,000
4.5	4.8	7.0	SB-3001	2,500
4.5	4.8	8.0	SB-304580	2,000
4.5	4.8	9.0	SB-304590	1,500
4.5	4.8	10.0	SB-3007	1,500
5.0	5.3	3.0	SB-305030	4,000
5.0	5.3	3.5	SB-305035	4,000
5.0	5.3	4.0	SB-305040	3,000
5.0	5.3	5.0	SB-305050	2,500
5.0	5.3	5.3	SB-3004	3,000
5.0	5.3	6.0	SB-305060	2,000
5.0	5.3	6.5	SB-3005	2,000
5.5	5.8	3.0	SB-305530	3,000
5.5	5.8	4.0	SB-305540	3,000
5.5	5.8	5.0	SB-305550	2,000
5.5	5.8	6.0	SB-305560	1,500

D1	D2	L	Part No.	Pieces / Box
5.5	5.8	7.0	SB-3002	1,500
5.5	5.8	9.0	SB-3003	1,000

Thread M3.5×0.6

D1	D2	L	Part No.	Pieces / Box
5.0	5.3	6.5	SB-3503	2,000
5.5	5.8	7.0	SB-3501	1,500
5.5	5.8	9.0	SB-3502	1,000

Thread M4×0.7

D1	D2	L	Part No.	Pieces / Box
5.5	5.8	3.0	SB-405530	4,000
5.5	5.8	4.0	SB-405540	3,000
5.5	5.8	5.0	SB-405550	2,000
5.5	5.8	5.8	SB-4005	2,000
5.5	5.8	6.0	SB-405560	2,000
5.5	5.8	7.0	SB-4002	1,500
5.5	5.8	8.0	SB-405580	1,500
5.5	5.8	9.0	SB-4001	1,000
6.0	6.3	5.0	SB-406050	2,000
6.0	6.3	6.0	SB-406060	1,500
6.0	6.3	8.0	SB-406080	1,000
6.0	6.3	12.0	SB-4006	800
6.5	6.8	5.0	SB-406550	1,500
6.5	6.8	6.0	SB-406560	1,500

D1	D2	L	Part No.	Pieces / Box
6.5	6.8	7.0	SB-406570	1,200
6.5	6.8	8.0	SB-4003	1,000
6.5	6.8	11.0	SB-4004	800

Thread M5×0.8

D1	D2	L	Part No.	Pieces / Box
6.5	6.8	3.5	SB-506535	2,000
6.5	6.8	5.5	SB-506555	1,500
6.5	6.8	6.8	SB-5004	1,200
6.5	6.8	8.0	SB-5002	800
6.5	6.8	11.0	SB-5001	800
8.0	8.3	5.0	SB-508050	1,000
8.0	8.3	9.0	SB-5003	600

Thread M6×1

D1	D2	L	Part No.	Pieces / Box
8.0	8.3	6.0	SB-6003	1,000
8.0	8.3	9.0	SB-6002	600
8.0	8.3	13.0	SB-6001	400

Thread M8×1.25

D1	D2	L	Part No.	Pieces / Box
11.0	11.3	13.0	SB-8002	800

FB (Flange Bit)

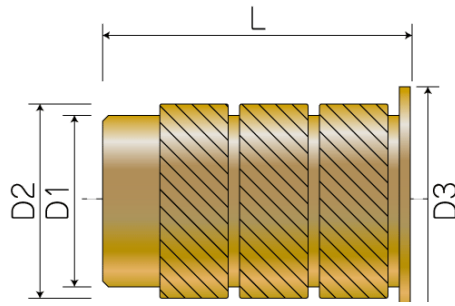

Thread M2×0.4

D1	D2	D3	L	Part No.	Pieces / Box
3.0	3.3	4.0	3.0	FB-2001	8,000
3.5	3.8	4.5	4.5	FB-204545	5,000

Thread M2.6×0.45

D1	D2	D3	L	Part No.	Pieces / Box
4.0	4.3	5.0	5.0	FB-2601	4,000
4.5	4.8	5.5	5.5	FB-2602	3,000

Thread M3×0.5

D1	D2	D3	L	Part No.	Pieces / Box
4.5	4.8	5.5	3.0	FB-305530	5,000
4.5	4.8	5.5	5.5	FB-3001	3,000
4.5	4.8	5.5	8.0	FB-305580	2,000
5.0	5.3	6.5	4.0	FB-306540	2,500
5.0	5.3	6.5	5.0	FB-306550	2,000
5.0	5.3	6.5	6.5	FB-3002	1,500
5.0	5.3	6.5	9.0	FB-306590	1,200

Thread M4×0.7

D1	D2	D3	L	Part No.	Pieces / Box
5.5	5.8	6.5	3.5	FB-406535	3,000

D1	D2	D3	L	Part No.	Pieces / Box
5.5	5.8	6.5	6.5	FB-4001	1,500
5.5	5.8	8.0	8.0	FB-4003	1,000
5.5	5.8	6.5	10.0	FB-4065100	1,000
6.5	6.8	8.0	5.0	FB-408050	1,500
6.5	6.8	8.0	8.0	FB-4002	800

Thread M5×0.8

D1	D2	D3	L	Part No.	Pieces / Box
6.5	6.8	8.0	8.0	FB-5001	1,000
8.0	8.3	10.0	10.0	FB-5002	500

Thread M6×1.0

D1	D2	D3	L	Part No.	Pieces / Box
8.0	8.3	10.0	10.0	FB-6001	500

Thread M8×1.25

D1	D2	D3	L	Part No.	Pieces / Box
11.0	11.3	13.0	9.0	FB-8001	1,000